

Similar Image



# HV throttling pendulum valve, RS-232 controller

DN 300 JIS, RS232 controller, bright dipped finish, 24 V DC ( $\pm 5\%$ )

Part number: TPVQPNG-C139

Nor-Cal Products



by PFEIFFER VACUUM

## HV throttling pendulum valve, RS-232 controller DN 300 JIS, RS232 controller, bright dipped finish, 24 V DC ( $\pm 5\%$ )

- Adaptive algorithm for improved stability and faster transitions
- Space saving, low cost design
- High reliability, low particle generation
- Can be operated in any orientation
- Body can be heated up to 120°C with optional heater jackets
- CE marked/fully REACH and RoHS compliant



Similar Image

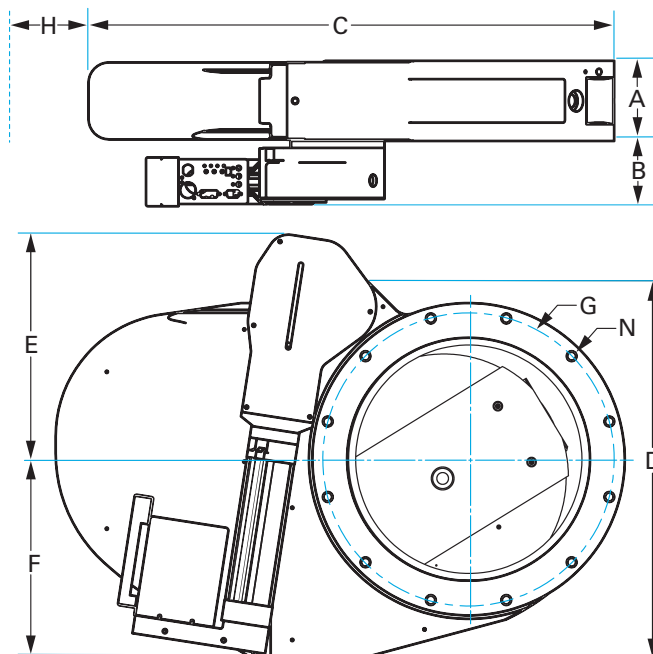

Dimensions (in inches)	
Dim A	4.72"
Dim B	4.02"
Dim D	22.8"
Dim E	12.0"
Dim F	11.7"
Dim G	14.6"
Dim H	10.6"
Bolt Hole Thread	M12
Thread Depth	0.709"
# Bolt Holes	12

### TPVQPNG-C139

Parameters	Specifications
Valve / Flange Size	DN 300 JIS
Communications Interface	RS232
Finish	Bright Dipped
Additional Controller Features	Gauge Supply
Flange Size / Type	DN 300 JIS
Controller Communications	RS232 system interface; RS232 service port
Supply Voltage	24 V DC ( $\pm 5\%$ )
Power Connector	XLR, 5-pin, Female
Gauge Power Supply	$\pm 15$ V DC ( $\pm 5\%$ ), 1.4 A max.
Power Fail Option	not included
Pressure Range	$3.8 \cdot 10^{-8}$ mbar to 1.1 bar

**HV throttling pendulum valve, RS-232 controller**  
**DN 300 JIS, RS232 controller, bright dipped finish, 24 V DC ( $\pm 5\%$ )**

**TPVQPNG-C139**

Parameters <i>(Continued)</i>	Specifications <i>(Continued)</i>
Max Differential at Opening	39 mbar
Max Temp (body)	150 °C
Temp. Limits (actuator)	5 °C (minimum), 45 °C (maximum)
Open / Close Time	6.5 s/5.5 s
Open Conductance	30000 l/s
Min. Control Conductance	0.1 l/s
Material (valve body)	A356 Aluminum
Material (valve mechanism)	304 Stainless & 6061-T6 Aluminum
Gate Seal	FKM
Bonnet Seal	FKM
Leak Rate (body)	$1 \cdot 10^{-9}$ mbar l/s
Leak Rate (gate)	$1 \cdot 10^{-9}$ mbar l/s
Service Life	1 million cycles
Weight	122.98 lbs

## VACUUM SOLUTIONS FOR INDUSTRY & RESEARCH

Nor-Cal Products is a premier global source for custom and standard high and ultra-high vacuum chambers and components critical to the success of industrial, semiconductor, coating, analytics, and research applications. We offer an extensive selection of vacuum line fittings, hardware, valves and components which complement our custom manufacturing capabilities.

## EARNING YOUR TRUST

Innovative engineering, precision manufacturing, exceptional service and expert technical support are cornerstones of our corporate culture and continuous improvement goals. Your trust is our most important asset.

## INNOVATION SINCE 1962

An added value to working with Nor-Cal Products is how we apply our vacuum science and industry expertise to your production and research goals and timelines. We continue to develop new component lines and services to serve the demands of the exciting and ever emerging applications that require vacuum components.

### Nor-Cal Products

Headquarters: USA

1-800-824-4166 or 530-842-4457

[nccsales@n-c.com](mailto:nccsales@n-c.com)

[www.n-c.com](http://www.n-c.com)



RoHS2/REACH compliant  
Conflict mineral regulations enforced

All data subject to change without prior notice.

Nor-Cal Products



by PFEIFFER VACUUM